

TO:

FROM: 焜新达技术部

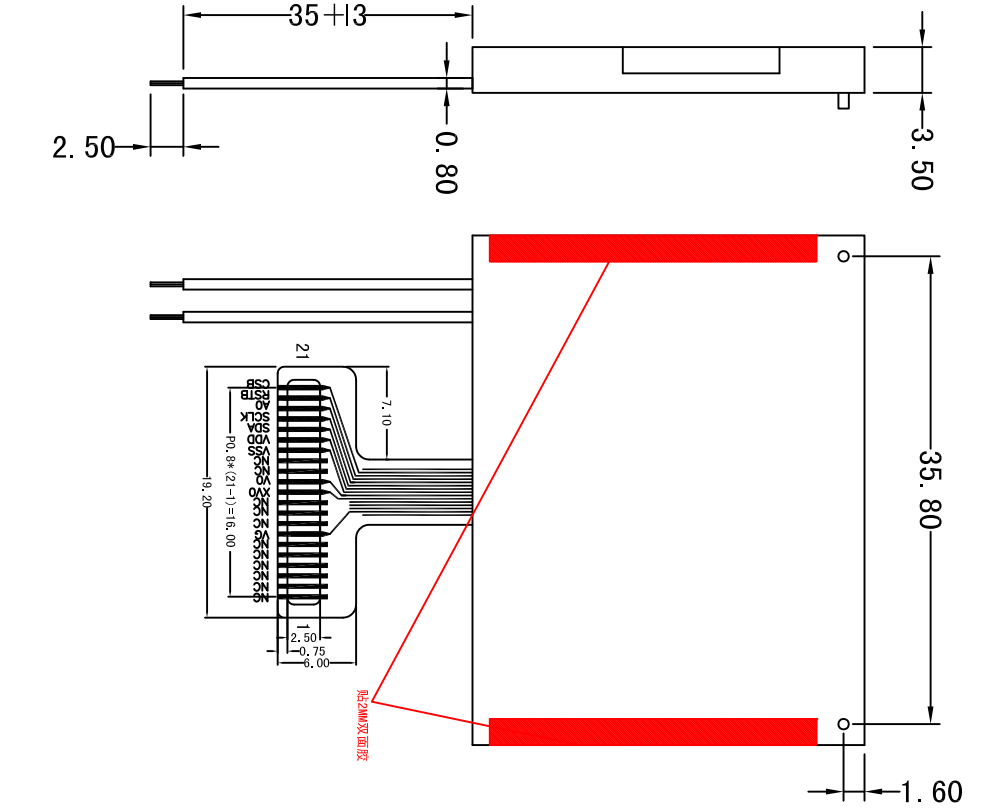
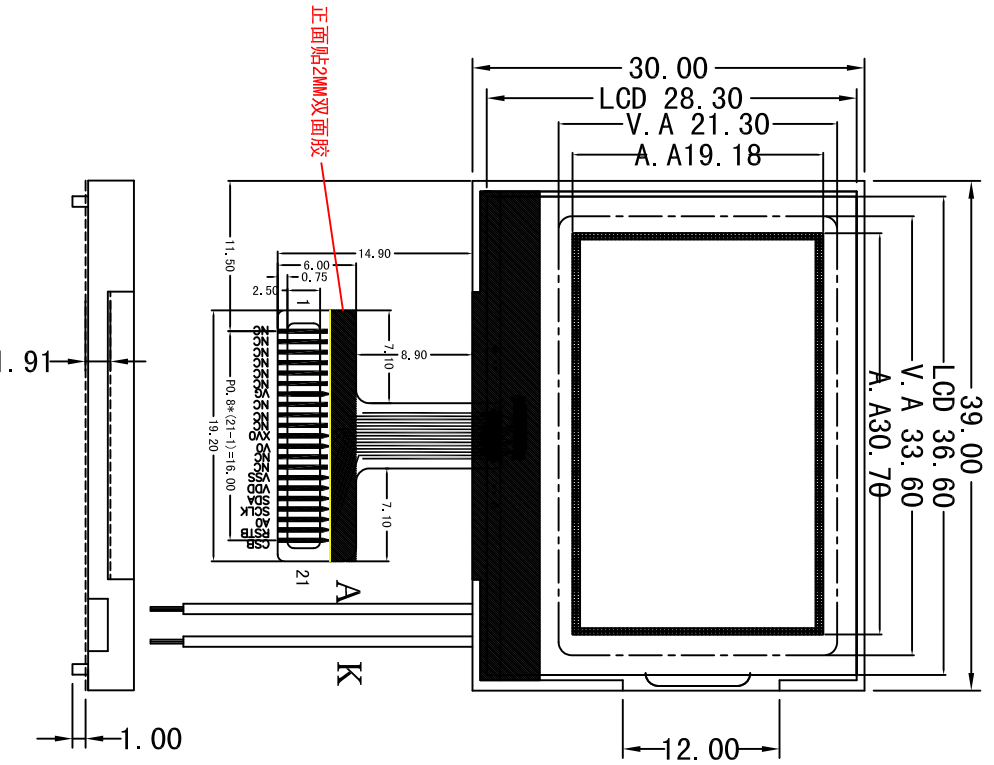

PIN	Symbol	I
1-6	NC	
7	VG	
8-10	NC	
11	XV0	
12	V0	
13-14	NC	
15	VSS	
16	VDD	
17	SDA	
18	SCLK	
19	A0	
20	REST	
21	CS	

Circuit Diagram LED 1x2=2Dies

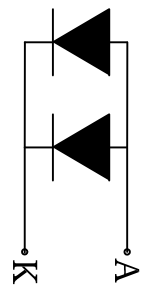

LCD-FSTN

VIEW ANGLE: 6 0'CLOCK	DISPLAY MODE: POSITIVE/HIGH-TRANSPARENT
DRIVE MODE: 1/65D,1/9B	OPERATE TEMP: -10°C T0 +60°C
DRIVE VOLTAGE: 9.0V	STORAGE TEMP: -20°C T0 +70°C
THE LCM: FPC+COG IC+LCD	DRIVING IC: ST7567

REVISION RECORD

1:	正面贴2MM双面胶
2:	
3:	

SHENZHEN YEXINDA INDUSTRY CO., LTD.

DRAWN BY: HGY	LCM NO: YXD-1286413A
APPROVED:	UNIT: mm
DATE: 2012-12-26	SHEET NO: 1 OF 2

REV	B
-----	---

TO:

FROM: 烨新达技术部

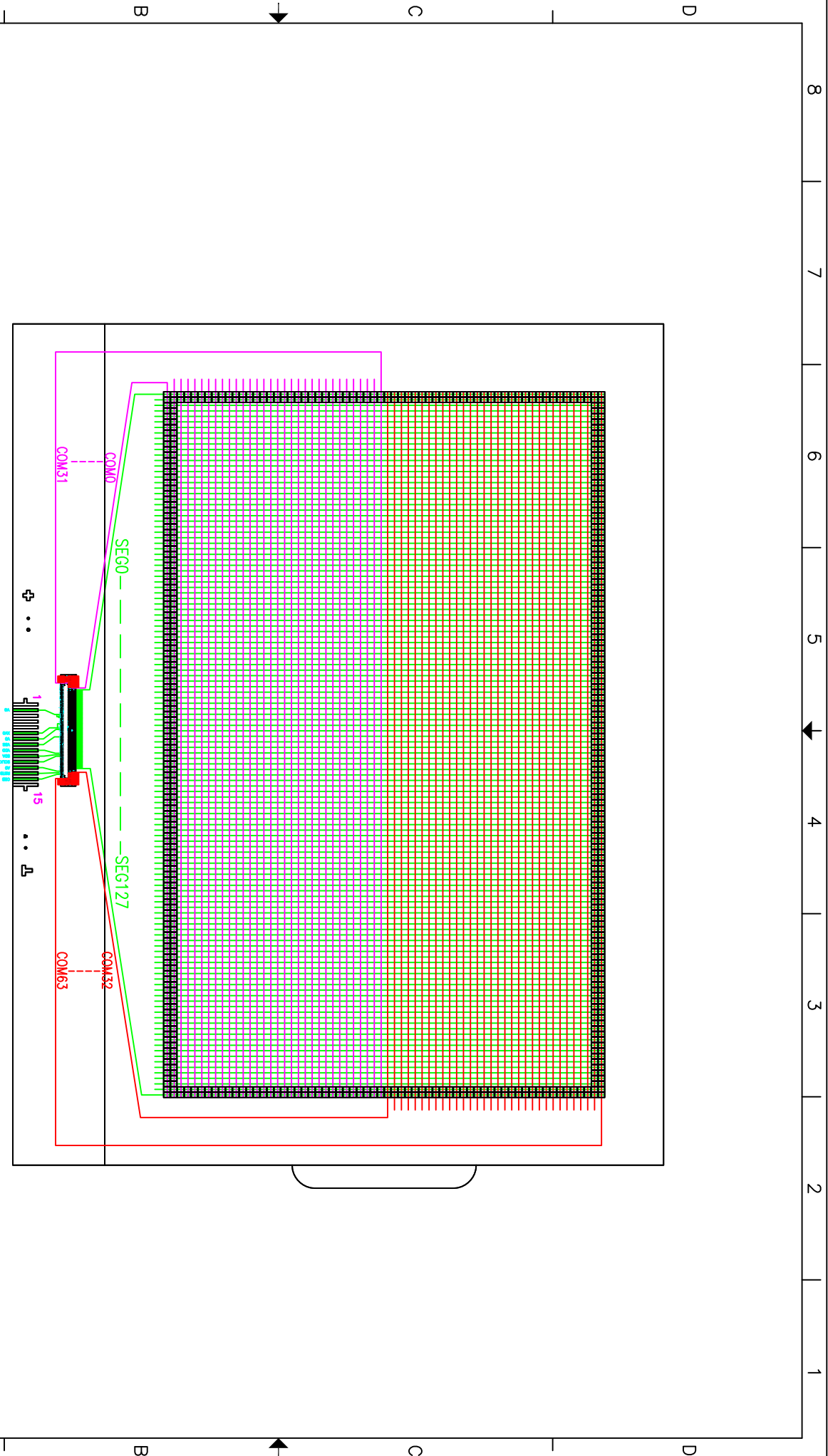

LCD-FSTN

VIEW ANGLE: 6 0'CLOCK DISPLAY MODE: POSITIVE/HIGH-TRANSPARENT

DRIVE MODE:1/65D,1/9B OPERATE TEMP: -10°C TO +60°C

DRIVE VOLTAGE: 9.0V STORAGE TEMP: -20°C TO +70°C

THE LCM: FPC+COG IC+LCD DRIVING IC: ST7567

REVISION RECORD

1:

2:

3:

SHENZHEN YEXINDA INDUSTRY CO., LTD.

DRAWN BY: HGY LCM NO:YXD-1286413A

APPROVED: UNIT: mm

DATE: 2012-12-26 SHEET NO: 2 OF 2

REV B